

**SAE 070109**

Ref. Aeroquip 900599  
 Ref. Parker PNTX / 03CP  
 Ref. Weatherhead C5229

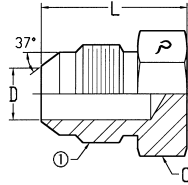

**2408**  
**Tube Plug**

2408-① ① -MJ	Tube O.D.	① Male JIC	C Hex	D Drill	L Length	Operating Pressure
2408-02 <i>Solid</i>	1/8	5/16 - 24	7/16	Solid	0.70	7,500
2408-03	3/16	3/8 - 24	7/16	0.125	0.73	7,500
2408-04	1/4	7/16 - 20	1/2	0.172	0.80	7,500
2408-05	5/16	1/2 - 20	9/16	0.234	0.80	6,000
2408-06	3/8	9/16 - 18	5/8	0.297	0.84	6,000
2408-08	1/2	3/4 - 16	13/16	0.391	0.94	6,000
2408-10	5/8	7/8 - 14	15/16	0.484	1.10	5,000
2408-12	3/4	1 1/16 - 12	1 1/8	0.609	1.28	5,000
2408-14 <i>Solid</i>	7/8	1 3/16 - 12	1 1/4	Solid	1.31	5,000
2408-16	1"	1 5/16 - 12	1 3/8	0.844	1.33	4,500
2408-20	1 1/4	1 5/8 - 12	1 11/16	1.078	1.45	4,000
2408-24	1 1/2	1 7/8 - 12	2"	1.312	1.65	4,000
2408-32	2"	2 1/2 - 12	2 5/8	1.781	2.05	2,000

37° JIC  
Flare

4:1 Safety Factor