

SAE 071502

Ref. Aeroquip 202411
 Ref. Parker CCTX / 5603
 Ref. Weatherhead C5425

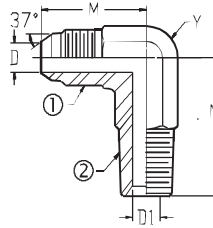

2501L
Male Elbow Long

2501L-①-② ① -MJ ② -MP	Tube O.D.	① Male JIC	② Male NPTF	D Drill	D1 Drill	M Length	N Length	Y Flats	Operating Pressure
2501L-04-02-4	1/4	7/16 - 20	1/8 - 27	0.172	0.188	0.89	1.19	7/16	6,000
2501L-04-04-4	1/4	7/16 - 20	1/4 - 18	0.172	0.281	1.05	1.56	9/16	6,000
2501L-05-02-4	5/16	1/2 - 20	1/8 - 27	0.234	0.188	0.95	1.17	9/16	6,000
2501L-05-04-4	5/16	1/2 - 20	1/4 - 18	0.234	0.281	1.05	1.58	9/16	6,000
2501L-06-04-4	3/8	9/16 - 18	1/4 - 18	0.297	0.281	1.06	1.58	9/16	6,000
2501L-06-06-4	3/8	9/16 - 18	3/8 - 18	0.297	0.406	1.14	1.82	3/4	6,000
2501L-06-08-4	3/8	9/16 - 18	1/2 - 14	0.297	0.531	1.22	2.17	7/8	6,000
2501L-08-04	1/2	3/4 - 16	1/4 - 18	0.391	0.281	1.25	1.67	13/16	6,000
2501L-08-06-4	1/2	3/4 - 16	3/8 - 18	0.391	0.406	1.25	1.82	3/4	6,000
2501L-08-08-4	1/2	3/4 - 16	1/2 - 14	0.391	0.531	1.33	2.17	7/8	6,000
2501L-08-12-4	1/2	3/4 - 16	3/4 - 14	0.391	0.719	1.42	2.44	1 1/16	4,000
2501L-10-06	5/8	7/8 - 14	3/8 - 18	0.484	0.531	1.45	1.98	7/8	5,000
2501L-10-08	5/8	7/8 - 14	1/2 - 14	0.484	0.531	1.45	2.17	7/8	5,000
2501L-10-12	5/8	7/8 - 14	3/4 - 14	0.484	0.719	1.55	2.44	1 1/8	4,000
2501L-12-12-4	3/4	1 1/16 - 12	3/4 - 14	0.609	0.719	1.66	2.41	1 1/16	4,000
2501L-14-12-4	7/8	1 3/16 - 12	3/4 - 14	0.719	0.719	1.80	2.66	1 3/16	4,000
2501L-16-16-4	1"	1 5/16 - 12	1 - 11 1/2	0.844	0.938	1.81	3.01	1 5/16	3,000
2501L-20-20-4	1 1/4	1 5/8 - 12	1 1/4 - 11 1/2	1.078	1.250	2.06	3.01	1 5/8	2,500
2501L-24-24	1 1/2	1 7/8 - 12	1 1/2 - 11 1/2	1.312	1.500	2.33	4.11	2"	2,000

37° JIC
Flare

4:1 Safety Factor

i Informational Tips
 Ask for our **Stainless Steel** catalog.

i Informational Tips
CAUTION:
Brazing or Welding on plated surfaces can give off toxic fumes resulting in personal injury and/or death.