

37° JIC Flare

PRESSURE CONNECTIONS CORP.

2603 Union Tee

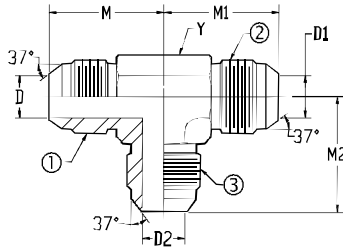

SAE 070401

Ref. Aeroquip 2033
Ref. Parker JTX / 033T
Ref. Weatherhead C5705

37° JIC
Flare

| 2603-①-②-③ ①-MJ ②-MJ ③-MJ | Tube O.D. | ① Male JIC | ② Male JIC | ③ Male JIC | D Drill | D1 Drill | D2 Drill | M Length | M1 Length | M2 Length | Y Flats | Operating Pressure |
|------------------------------|--------------|---------------|---------------|---------------|------------|-------------|-------------|-------------|--------------|--------------|------------|-----------------------|
| 2603-02-02-02-4 | 1/8 | 5/16 - 24 | 5/16 - 24 | 5/16 - 24 | 0.062 | 0.062 | 0.062 | 0.77 | 0.77 | 0.77 | 7/16 | 7,500 |
| 2603-03-03-03-4 | 3/16 | 3/8 - 24 | 3/8 - 24 | 3/8 - 24 | 0.125 | 0.125 | 0.125 | 0.83 | 0.83 | 0.83 | 7/16 | 7,500 |
| 2603-04-04-04-4 | 1/4 | 7/16 - 20 | 7/16 - 20 | 7/16 - 20 | 0.172 | 0.172 | 0.172 | 0.89 | 0.89 | 0.89 | 7/16 | 7,500 |
| 2603-05-05-05-4 | 5/16 | 1/2 - 20 | 1/2 - 20 | 1/2 - 20 | 0.234 | 0.234 | 0.234 | 0.95 | 0.95 | 0.95 | 9/16 | 6,000 |
| 2603-06-06-06-4 | 3/8 | 9/16 - 18 | 9/16 - 18 | 9/16 - 18 | 0.297 | 0.297 | 0.297 | 1.06 | 1.06 | 1.06 | 9/16 | 6,000 |
| 2603-06-06-08-4 | 3/8 x 1/2 | 9/16 - 18 | 9/16 - 18 | 3/4 - 16 | 0.297 | 0.297 | 0.391 | 1.15 | 1.15 | 1.23 | 3/4 | 6,000 |
| 2603-06-08-08-4 | 3/8 x 1/2 | 9/16 - 18 | 3/4 - 16 | 3/4 - 16 | 0.297 | 0.391 | 0.391 | 1.21 | 1.23 | 1.23 | 3/4 | 6,000 |
| 2603-08-06-06 | 1/2 x 3/8 | 3/4 - 16 | 9/16 - 18 | 9/16 - 18 | 0.391 | 0.297 | 0.297 | 1.23 | 1.21 | 1.21 | 13/16 | 6,000 |
| 2603-08-08-06 | 1/2 x 3/8 | 3/4 - 16 | 3/4 - 16 | 9/16 - 18 | 0.391 | 0.391 | 0.297 | 1.25 | 1.25 | 1.15 | 13/16 | 6,000 |
| 2603-08-08-08-4 | 1/2 | 3/4 - 16 | 3/4 - 16 | 3/4 - 16 | 0.391 | 0.391 | 0.391 | 1.25 | 1.25 | 1.25 | 3/4 | 6,000 |
| 2603-08-08-10-4 | 1/2 x 5/8 | 3/4 - 16 | 3/4 - 16 | 7/8 - 14 | 0.391 | 0.391 | 0.484 | 1.35 | 1.35 | 1.45 | 7/8 | 5,000 |
| 2603-10-10-08-4 | 5/8 x 1/2 | 7/8 - 14 | 7/8 - 14 | 3/4 - 16 | 0.484 | 0.484 | 0.391 | 1.45 | 1.45 | 1.35 | 7/8 | 5,000 |
| 2603-10-10-08 | 5/8 x 1/2 | 7/8 - 14 | 7/8 - 14 | 3/4 - 16 | 0.484 | 0.484 | 0.391 | 1.45 | 1.45 | 1.35 | 15/16 | 5,000 |
| 2603-10-10-10-4 | 5/8 | 7/8 - 14 | 7/8 - 14 | 7/8 - 14 | 0.484 | 0.484 | 0.484 | 1.45 | 1.45 | 1.45 | 7/8 | 5,000 |
| 2603-12-12-08-4 | 3/4 x 1/2 | 1 1/16 - 12 | 1 1/16 - 12 | 3/4 - 16 | 0.609 | 0.609 | 0.391 | 1.66 | 1.66 | 1.42 | 1 1/16 | 5,000 |
| 2603-12-12-12-4 | 3/4 | 1 1/16 - 12 | 1 1/16 - 12 | 1 1/16 - 12 | 0.609 | 0.609 | 0.609 | 1.66 | 1.66 | 1.66 | 1 1/16 | 5,000 |
| 2603-12-12-16 | 3/4 x 1" | 1 1/16 - 12 | 1 1/16 - 12 | 1 5/16 - 12 | 0.609 | 0.609 | 0.844 | 1.78 | 1.81 | 1.81 | 1 3/8 | 4,000 |
| 2603-14-14-14-4 | 7/8 | 1 3/16 - 12 | 1 3/16 - 12 | 1 3/16 - 12 | 0.719 | 0.719 | 0.719 | 1.80 | 1.80 | 1.80 | 1 5/16 | 5,000 |
| 2603-16-16-12-4 | 1" x 3/4 | 1 5/16 - 12 | 1 5/16 - 12 | 1 1/16 - 12 | 0.844 | 0.844 | 0.609 | 1.81 | 1.78 | 1.78 | 1 5/16 | 4,000 |
| 2603-16-16-16-4 | 1" | 1 5/16 - 12 | 1 5/16 - 12 | 1 5/16 - 12 | 0.844 | 0.844 | 0.844 | 1.81 | 1.81 | 1.81 | 1 5/16 | 4,000 |
| 2603-20-20-20-4 | 1 1/4 | 1 5/8 - 12 | 1 5/8 - 12 | 1 5/8 - 12 | 1.078 | 1.078 | 1.078 | 2.06 | 2.06 | 2.06 | 1 5/8 | 4,000 |
| 2603-24-24-24-4 | 1 1/2 | 1 7/8 - 12 | 1 7/8 - 12 | 1 7/8 - 12 | 1.312 | 1.312 | 1.312 | 2.33 | 2.33 | 2.33 | 1 7/8 | 3,000 |
| 2603-32-32-32 | 2" | 2 1/2 - 12 | 2 1/2 - 12 | 2 1/2 - 12 | 1.781 | 1.781 | 1.781 | 3.06 | 3.06 | 3.06 | 2 5/8 | 2,000 |

4:1 Safety Factor

37° JIC Flare information is on page 64.