

**SAE J514**

Ref. Aeroquip 206801  
 Ref. Parker A0EG  
 Ref. Weatherhead C3459

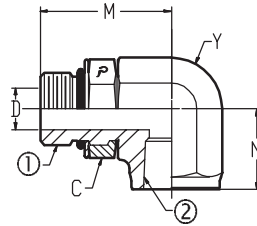

**6805**

**ORB Female Elbow**  
**Male O-Ring Boss x Female Pipe**

6805-①-② ① -MB ② -FP	① Male ORB	② Female NPTF	C Nut Hex	D Drill	M Length	N Length	Y Flats	Operating Pressure
6805-04-02-4	7/16 - 20	1/8 - 27	9/16	0.172	1.09	0.66	9/16	5,000
6805-04-04-4	7/16 - 20	1/4 - 18	9/16	0.172	1.17	0.88	3/4	5,000
6805-05-02	1/2 - 20	1/8 - 27	5/8	0.234	1.16	0.66	5/8	5,000
6805-06-04-4	9/16 - 18	1/4 - 18	11/16	0.297	1.31	0.88	3/4	5,000
6805-06-06-4	9/16 - 18	3/8 - 18	11/16	0.297	1.31	0.71	7/8	4,500
6805-08-06-4	3/4 - 16	3/8 - 18	7/8	0.391	1.50	1.03	7/8	4,500
6805-08-08-4	3/4 - 16	1/2 - 14	7/8	0.391	1.56	1.23	1 1/16	3,000
6805-10-08-4	7/8 - 14	1/2 - 14	1"	0.484	1.81	1.20	1 1/16	3,000
6805-12-08	1 1/16 - 12	1/2 - 14	1 1/4	0.609	1.94	1.23	1 1/8	3,000
6805-12-12-4	1 1/16 - 12	3/4 - 14	1 1/4	0.609	2.00	0.81	1 5/16	3,000
6805-14-12-4	1 3/16 - 12	3/4 - 14	1 3/8	0.719	2.06	1.42	1 5/16	3,000
6805-16-16-4	1 5/16 - 12	1 - 11 1/2	1 1/2	0.844	2.25	1.62	1 5/8	1,800
6805-20-20-4	1 5/8 - 12	1 1/4 - 11 1/2	1 7/8	1.078	2.38	1.70	1 7/8	1,500
6805-32-32-4	2 1/2 - 12	2 - 11 1/2	2 3/4	1.781	3.00	2.38	2 13/16	1,200

4:1 Safety Factor

**SAE J514**

Ref. Aeroquip 206804  
 Ref. Parker A0E4G  
 Ref. Weatherhead C3469

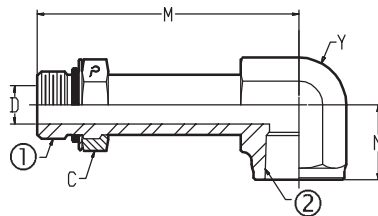

**6805LL**

**ORB Female Elbow**  
**Double Long**

O-Ring Boss  
 Fittings

6805LL-①-② ① -MB ② -FP	① Male ORB	② Female NPTF	C Nut Hex	D Drill	M Length	N Length	Y Flats	Operating Pressure
6805LL-08-06-4	3/4 - 16	3/8 - 18	7/8	0.391	2.92	0.66	7/8	4,500
6805LL-10-08-4	7/8 - 14	1/2 - 14	1"	0.484	3.56	0.99	1 1/16	3,000
6805LL-12-12-4	1 1/16 - 12	3/4 - 14	1 1/4	0.609	4.13	1.35	1 5/16	3,000
6805LL-16-16-4	1 5/16 - 12	1 - 11 1/2	1 1/2	0.844	4.63	1.62	1 5/8	1,800

4:1 Safety Factor