

SAE J514

Ref. Parker AOEX6

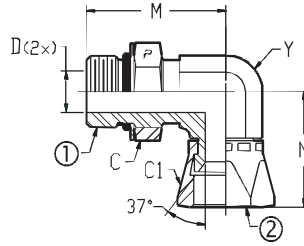

6809

Swivel Nut Elbow
Male ORB x Female JIC Swivel

6809-①-② ① -MB ② -FJX	① Male ORB	② Female JIC Swivel	C Nut Hex	C1 Nut Hex	D Drill	M Length	N Length	Y Flats	Operating Pressure
6809-04-04-4	7/16 - 20	7/16 - 20	9/16	9/16	0.172	1.03	0.94	7/16	6000
6809-06-06-4	9/16 - 18	9/16 - 18	7/8	11/16	0.297	1.29	1.23	9/16	5,000
6809-08-06-4	3/4 - 16	9/16 - 18	7/8	11/16	0.391	1.45	1.23	3/4	5,000
6809-08-08-4	3/4 - 16	3/4 - 16	7/8	7/8	0.391	1.45	1.38	3/4	5,000
6809-10-08	7/8 - 14	3/4 - 16	1"	7/8	0.484	1.70	1.44	15/16	5,000
6809-10-10-4	7/8 - 14	7/8 - 14	1"	1"	0.484	1.70	1.62	7/8	5,000
6809-12-12-4	1 1/16 - 12	1 1/16 - 12	1 1/4	1 1/4	0.609	1.94	1.75	1 1/16	5,000
6809-16-16-4	1 5/16 - 12	1 5/16 - 12	1 1/2	1 1/2	0.844	2.05	2.01	1 5/16	3,600
6809-20-20	1 5/8 - 12	1 5/8 - 12	1 7/8	2"	1.078	2.25	2.31	1 3/4	3,600

4:1 Safety Factor

SAE J514

Ref. Parker AOEG5

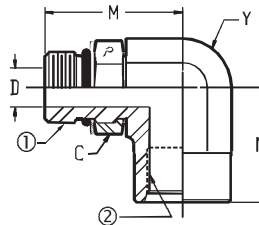

6815

Straight Thread Elbow
Male x Female ORB Union

6815-①-② ① -MB ② -FB	① Male ORB	② Female ORB	C Nut Hex	D Drill	M Length	N Length	Y Flats	Operating Pressure
6815-04-04-4	7/16 - 20	7/16 - 20	9/16	0.172	1.23	0.63	3/4	5,000
6815-06-06-4	9/16 - 18	9/16 - 18	11/16	0.297	1.38	0.75	7/8	5,000
6815-08-08-4	3/4 - 16	3/4 - 16	7/8	0.391	1.59	0.88	1 1/16	5,000
6815-12-12-4	1 1/16 - 12	1 1/16 - 12	1 1/4	0.609	2.00	1.21	1 5/16	3,000

4:1 Safety Factor

O-Ring Boss information is on pages 130–131, 155.

O-Ring Boss
Fittings