

5408

Square Socket Pipe Plug

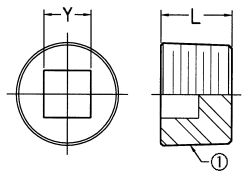

SAE 130109G

5408-① ① -MP	① Male NPTF	L Length	Y Flats	Operating Pressure
5408-02	1/8 - 27	0.30	3/16	6,000
5408-04	1/4 - 18	0.45	1/4	6,000
5408-06	3/8 - 18	0.46	5/16	6,000
5408-08	1/2 - 14	0.61	3/8	6,000
5408-12	3/4 - 14	0.62	1/2	5,500
5408-16	1 - 11 1/2	0.77	1/2	5,500
5408-20	1 1/4 - 11 1/2	0.82	3/4	5,000
5408-24	1 1/2 - 11 1/2	0.84	3/4	3,000
5408-32	2 - 11 1/2	0.89	7/8	2,500

4:1 Safety Factor

5409

Hex Socket Pipe Plug

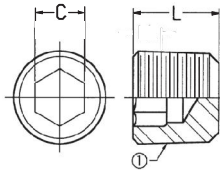

SAE 130109N

Ref. BRN 5406-HP
 Ref. Aeroquip 2222
 Ref. Parker HHP
 Ref. Weatherhead C3169

5409-① ① -MP	① Male NPTF	C Hex	L Length	Operating Pressure
5409-01	1/16 - 27	5/32	0.30	6,000
5409-02	1/8 - 27	3/16	0.30	6,000
5409-04	1/4 - 18	1/4	0.40	6,000
5409-04-Y Yellow Zinc	1/4 - 18	1/4	0.40	6,000
5409-06	3/8 - 18	5/16	0.46	6,000
5409-06-Y Yellow Zinc	3/8 - 18	5/16	0.46	6,000
5409-08	1/2 - 14	3/8	0.61	6,000
5409-08-Y Yellow Zinc	1/2 - 14	3/8	0.61	6,000
5409-12	3/4 - 14	9/16	0.62	5,500
5409-16	1 - 11 1/2	5/8	0.78	5,500
5409-20 ①	1 1/4 - 11 1/2	3/4	0.81	5,000
5409-24	1 1/2 - 11 1/2	3/4	0.75	3,000
5409-32	2 - 11 1/2	3/4	0.75	2,500

① Non-Standardized dimensions.

4:1 Safety Factor

Pipe Fittings