

FS-6400

O-Ring Face Seal Fittings OFS Straight Thread Connector

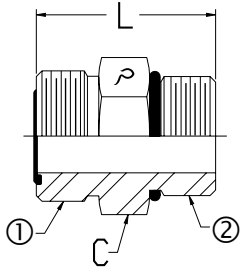

Reference
Aeroquip FF1852T0403
Parker Tube F50LO
Weatherhead 4315
SAE 520120

Part No.	Tube O.D.	1 Male OFS	2 Male ORB	C Hex	L Length	Operating Pressure
FS-6400-04-03 #	1/4	9/16 - 18	3/8 - 24	5/8	0.70	9,200
FS-6400-04-04	1/4	9/16 - 18	7/16 - 20	5/8	1.13	9,200
FS-6400-04-05 #	1/4	9/16 - 18	1/2 - 20	5/8	1.13	9,200
FS-6400-04-06	1/4	9/16 - 18	9/16 - 18	3/4	1.20	9,200
FS-6400-04-08	1/4	9/16 - 18	3/4 - 16	7/8	1.32	9,200
FS-6400-06-04	3/8	11/16 - 16	7/16 - 20	3/4	1.34	9,200
FS-6400-06-06	3/8	11/16 - 16	9/16 - 18	3/4	1.25	9,200
FS-6400-06-08	3/8	11/16 - 16	3/4 - 16	7/8	1.38	9,200
FS-6400-06-10	3/8	11/16 - 16	7/8 - 14	1"	1.53	9,200
FS-6400-06-12	3/8	11/16 - 16	1 1/16 - 12	1 1/4	1.69	9,200
FS-6400-08-06	1/2	13/16 - 16	9/16 - 18	7/8	1.47	9,200
FS-6400-08-08	1/2	13/16 - 16	3/4 - 16	7/8	1.44	9,200
FS-6400-08-10	1/2	13/16 - 16	7/8 - 14	1"	1.59	6,000
FS-6400-08-12	1/2	13/16 - 16	1 1/16 - 12	1 1/4	1.75	6,000
FS-6400-08-16	1/2	13/16 - 16	1 5/16 - 12	1 1/2	1.79	6,000
FS-6400-10-08	5/8	1 - 14	3/4 - 16	1 1/16	1.78	6,000
FS-6400-10-10	5/8	1 - 14	7/8 - 14	1 1/16	1.70	6,000
FS-6400-10-12	5/8	1 - 14	1 1/16 - 12	1 1/4	1.86	6,000
FS-6400-12-08	3/4	1 3/16 - 12	3/4 - 16	1 1/4	1.91	6,000
FS-6400-12-10	3/4	1 3/16 - 12	7/8 - 14	1 1/4	1.99	6,000
FS-6400-12-12	3/4	1 3/16 - 12	1 1/16 - 12	1 1/4	1.92	6,000
FS-6400-12-16	3/4	1 3/16 - 12	1 5/16 - 12	1 1/2	1.96	6,000
FS-6400-16-12	1"	1 7/16 - 12	1 1/16 - 12	1 1/2	2.14	6,000
FS-6400-16-16	1"	1 7/16 - 12	1 5/16 - 12	1 1/2	1.98	6,000
FS-6400-16-20	1"	1 7/16 - 12	1 5/8 - 12	1 7/8	2.06	6,000
FS-6400-20-16	1 1/4	1 11/16 - 12	1 5/16 - 12	1 7/8	2.28	6,000
FS-6400-20-20	1 1/4	1 11/16 - 12	1 5/8 - 12	1 7/8	2.06	6,000
FS-6400-20-24	1 1/4	1 11/16 - 12	1 7/8 - 12	2 1/8	2.13	5,000
FS-6400-24-20	1 1/2	2 - 12	1 5/8 - 12	2 1/8	2.33	5,000
FS-6400-24-24	1 1/2	2 - 12	1 7/8 - 12	2 1/8	2.13	5,000

Minimum Order Quantity May Apply.

4:1 Safety Factor