

# 2407

## 37° JIC Flare Fittings JIC Tube Reducer INSERT

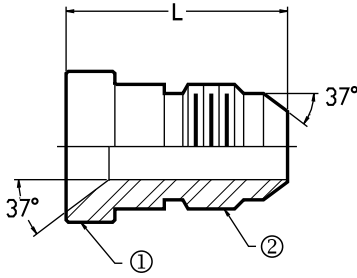

**Reference**  
Aeroquip 221501  
Parker Tube TRTXN  
Weatherhead C5015  
SAE 070123

Part No.	Tube O.D.	1 Female JIC	2 Male JIC	L Length	Operating Pressure
2407-06-04	3/8	9/16 - 18	7/16 - 20	0.97	6,000
2407-08-04 #	1/2	3/4 - 16	7/16 - 20	1.00	6,000
2407-08-06	1/2	3/4 - 16	9/16 - 18	1.00	6,000
2407-10-04 #	5/8	7/8 - 14	7/16 - 20	1.03	5,000
2407-10-06 #	5/8	7/8 - 14	9/16 - 18	1.03	5,000
2407-12-04 #	3/4	1 1/16 - 12	7/16 - 20	1.09	5,000
2407-12-06 #	3/4	1 1/16 - 12	9/16 - 18	1.09	5,000
2407-12-08 #	3/4	1 1/16 - 12	3/4 - 16	1.19	5,000
2407-16-04 #	1"	1 5/16 - 12	7/16 - 20	1.15	4,000
2407-16-06 #	1"	1 5/16 - 12	9/16 - 18	1.16	4,000
2407-16-08 #	1"	1 5/16 - 12	3/4 - 16	1.25	4,000
2407-16-10 #	1"	1 5/16 - 12	7/8 - 14	1.37	4,000
2407-16-12	1"	1 5/16 - 12	1 1/16 - 12	1.47	4,000
2407-20-08 #	1 1/4	1 5/8 - 12	3/4 - 16	1.34	4,000
2407-20-12 #	1 1/4	1 5/8 - 12	1 1/16 - 12	1.52	4,000
2407-20-16 #	1 1/4	1 5/8 - 12	1 5/16 - 12	1.54	4,000
2407-24-08 #	1 1/2	1 7/8 - 12	3/4 - 16	1.41	3,000
2407-24-10 #	1 1/2	1 7/8 - 12	7/8 - 14	1.51	3,000

● Available in 316 Stainless Steel

4:1 Safety Factor

Inserts into a JIC Tube Nut (318).

# Minimum Order Quantity May Apply.